

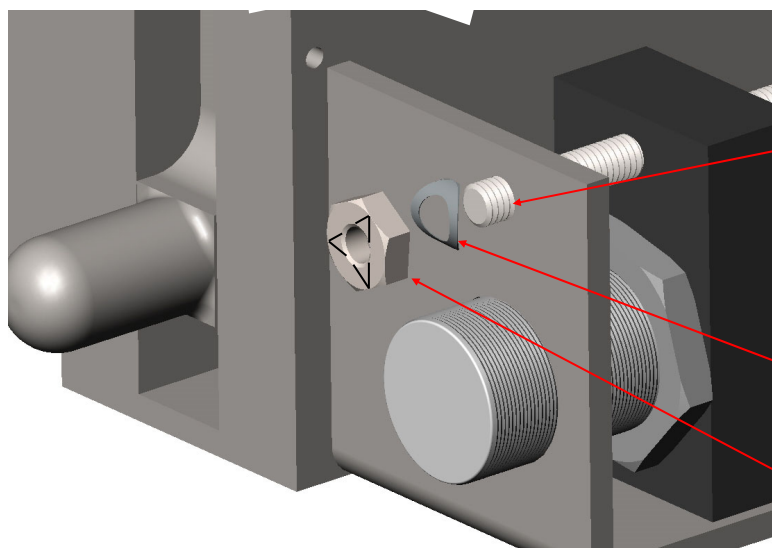

LOCK ASSEMBLY SENSOR NUT & WAVE WASHER REPLACEMENT



The compressed triangle must be toward the outside



Proximity Adjustment Screw

Wave Washer

Lock Nut

Tighten nut until there is a slight bend in the flange to create tension on the proximity screw.

Flange

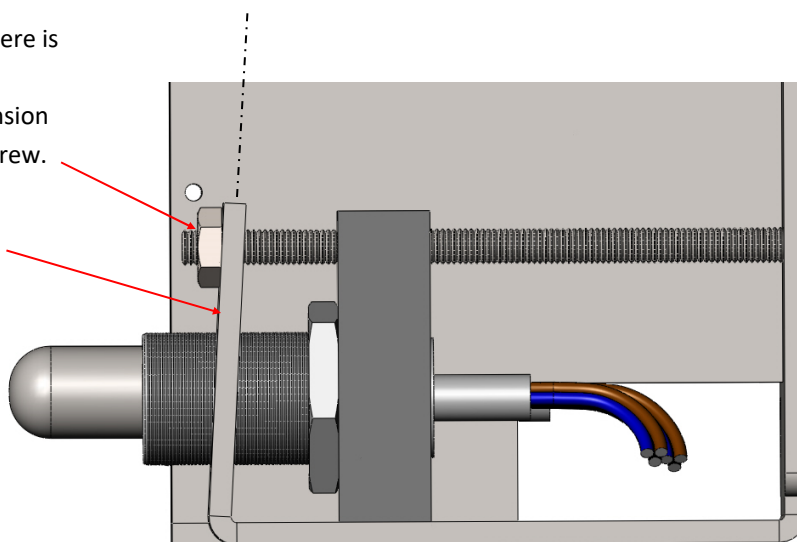

Proximity Screw

Re-install lock assembly and set the gap distance with the feeler gauge.